



PROGRAM

Montgomery Bell State Park
October 9 -10, 2008



*Today's Farms for Tomorrow's
Families and Communities*

Thursday - October 9, 2008

- 7 a.m.** *Corridor & A1* **Booth Set-up**
- 8 a.m.** *Corridor* **Registration Opens**
- 9 a.m. - 9:15 a.m.** *Rooms B & C* **Opening Ceremonies**
Joe Gaines, Tennessee Department of Agriculture
Commissioner Ken Givens, Tennessee Department of Agriculture
Jeanie Nelson, Land Trust for Tennessee
- 9:15 a.m. - 9:45 a.m.** *Rooms B & C* **General Session**
Rhedona Rose, Tennessee Farm Bureau Federation
Importance of Agriculture in Tennessee
- 9:45 a.m. - 11:15 a.m.** *Rooms B & C* **General Session**
Dr. Ron Hanson, University of Nebraska
You Can Buy the Family Farm but Just Remember That I Still Own It
Dr. Hanson will focus directly on the 'family issues' of farm or family business ownership succession when one generation attempts to pass on the ownership and/or control of their family operation to the next generation.
- 11:15 a.m. - 11:30 a.m.** *Corridor & A1* **Break**
- 11:30 a.m. - 12:30 p.m.** *Rooms B & C* **Lunch**
Dr. David Ostermeier, University of Tennessee
Trends in Tennessee Forest Lands

Dr. Ostermeier will discuss forest land trends in Tennessee including changes in land sales in the Cumberlands and changing interests of forest land owners.
- 12:30 p.m. - 12:45 p.m.** *Corridor & A1* **Break**
- 12:45 p.m. - 1:45 p.m.** *Rooms B & C* **General Session**
Emily Parish, Land Trust for Tennessee
John Rissler, USDA/NRCS
Steven Fisher, TN Farmer
Karen Guy, TN Farmer
Understanding Conservation Easements

Learn more about conservation easements and the process of donating or selling development rights including the criteria and benefits for each. Listen to Tennessee farmers talk about why they chose a conservation easement.
- 1:45 p.m. - 2 p.m.** *Corridor & A1* **Break**

2 p.m. - 3 p.m.

Break-out Session 1 (Choose one)

(A) Community Session

Rooms A2 & A3

Dr. Bridget Jones, Cumberland Region Tomorrow

Land Policy Tools: Comprehensive Planning Case Study in Maury County

A comprehensive plan is a local government's adopted statement on future development. Come hear how Maury County, Columbia, Spring Hill and Mt Pleasant governments and appointed private sector leaders have come together to identify their community needs, including farm land, cultural and historic and natural land conservation, in the CRT region's first Quality Growth Toolbox Pilot Project county-wide comprehensive planning project.

(B) Farmer/Landowner Session

Rooms B & C

Barry Monson and John Allen, Division of Property Assessment

Greenbelt Program/Property Taxes

An overview of the Tennessee's Greenbelt Program to include: Legislation and Statutes, the 3 land types that qualify for Greenbelt classification, acceptable use, size limitations, application procedures, "Use Value" determination, removal and rollback provisions. A question and answers session will follow presentation.

3 p.m. - 3:15 p.m.

Corridor & A1 Break

3:15 p.m. - 5 p.m.

Break-out Session 2 (Choose One)

(A) Community Session

Rooms A2 & A3

Tim Roach, Dept. of Economic and Community Development

Land and Policy Tools: Conservation Subdivisions

ECD will discuss a development approach that has as its mission the integration of sensitive natural features with development plans that feature building lots and sites that also contain highly desirable recreation amenities doubling as preservation areas for working farmland or environmentally sensitive lands. ECD will review the concept and application of conservation subdivisions so that property owners and decision makers can include this concept in their range of development/preservation tools.

(B) Farmer/Landowner Session

Rooms B & C

Dr. Ron Hanson, University of Nebraska
Larry Wilks, Attorney
Farm Estate Planning

This session will focus on the key elements required for developing a farm business ownership succession strategy and farm estate plan. An important point to remember: if these family succession issues are not discussed and then resolved by all family members themselves, it could end up costing each farm family member a lot of legal costs and lawyer fees. Can the farm family afford that and the farming operation still survive to the next generation?

6 p.m. – 8 p.m.

***Outdoor Pavilion* Pick Tennessee Products Reception**

Friday - October 10, 2008

7:30 a.m. - 8:15 a.m.

Corridor & A1 Breakfast and Booths

8:15 a.m. - 8:30 a.m.

Rooms B&C Welcome Back

8:30 a.m. - 9:30 a.m.

Rooms B&C General Session

Planning for Agriculture

Gerry Cohn, American Farmland Trust

Gerry Cohn will talk about how farmers and communities can plan for an agricultural future. He will be covering topics such as: local government tools, agricultural districts, purchase of development rights, local farm viability and more.

9:30 a.m. - 10:10 a.m.

Rooms B&C General Session

Rural Stewardship

Steve Auterman and Hunter Gee, Looney Ricks Kiss Architects, Inc.

Steve Auterman and Hunter Gee will describe an incentive-based approach to rural and small-town development that addresses a holistic view of place-making, the decline of our natural and cultural resources and the rural way of life. Drawn from experiences from within and beyond Tennessee, they will discuss how Rural Stewardship can help raise the bar for sustainable development outside major metropolitan areas.

10:10 a.m. - 10:45 a.m.

Rooms B&C General Session

Cost of Community Services: Tipton, Blount, Robertson

Dr. Bridget Jones, Cumberland Region Tomorrow

A Cost of Community Services study performed by the American Farmland Trust is one national model that can be used to understand the cost of community services on a county-wide scale. Results of these studies can provide local government and community decision makers a snap shot in time description of the net cost to local county governments by land use types for a particular fiscal year. Come hear the results of three Tennessee based COCS studies.

10:45 a.m. - 11:30 a.m.

Corridor & A1 Break (allow for lunch set-up)

11:30 a.m. - 1:15 p.m.

Rooms B&C Century Farms Luncheon

Celebrating and Honoring Tennessee's Pioneer Farms

Caneta Hankins, Center for Historic Preservation

Commissioner Ken Givens, Tennessee Department of Agriculture

Governor Phil Bredesen

Luncheon is open to all attendees who want to come celebrate and honor Tennessee's oldest farms. Century Farms that were established before or during 1796 will be recognized.

1:15 p.m. - 1:30 p.m.

Corridor & A1 Break

1:30 p.m. - 2 p.m.

Rooms B&C General Session

Farmers and the Local Community

Rob Holland and Megan Bruch, Center for Profitable Agriculture

This session will look at how farmers and local communities can benefit from working together. Opportunities discussed will include Farmers Markets, Agritourism and Shared-Use Food Processing Facilities. The presentation will include background information, examples, benefits, pros and cons. The presenters will include various examples in their discussion.

2 p.m. - 2:45 p.m.

Rooms B&C Panel Presentation

Preserving Farms through Farm Profitability

Joe Gaines, Tennessee Department of Agriculture

The Tennessee Agricultural Enhancement Program

John Rissler, USDA/NRCS

NRCS Conservation Programs

Dan Beasley, USDA Rural Development:

USDA Rural development programs, grant, and ideas that can help farmers and communities keep land profitable

2:45pm-3:30pm

Rooms B&C Closing Session

Where from here?

Attendees get a chance to share their thoughts on the future of Tennessee Farms and Communities.

Please fill out the surveys so your answers and opinions can be discussed in the final session.

All PowerPoint Presentations will be available online after conference at:

<http://picktnproducts.org/legacy/>

Speaker Biographies



Governor Phil Bredesen

Governor Phil Bredesen took office as Tennessee's 48th governor in January 2003 and was re-elected in November 2006 in a landslide victory. In both professional and public life, Governor Bredesen has made significant contributions to the state in areas as diverse as health care, conservation and education.

Throughout his second term, Governor Bredesen will continue to focus on raising high school and college graduation rates, boosting the economies of Tennessee's smaller and mid-sized communities, strengthening public education at every level and promoting access to health care and healthier lifestyles for all citizens.

Governor Bredesen and his wife, First Lady Andrea Conte, are active members of the community, locally and statewide. He is a founding member of Nashville's Table and the Land Trust for Tennessee. Governor Bredesen grew up in rural Shortsville, N.Y., and earned a bachelor's degree in physics from Harvard University. Governor Bredesen and Conte have one son, Ben.

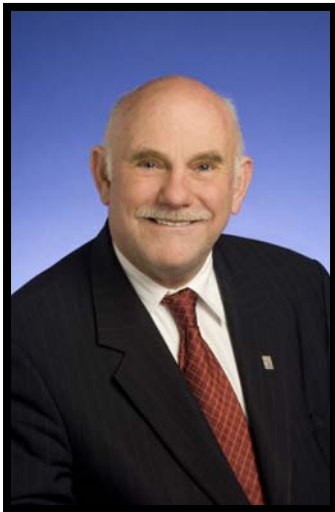

Ken Givens

Commissioner of Agriculture

Commissioner Ken Givens was appointed by Governor Phil Bredesen and became Tennessee's 34th Commissioner of Agriculture on Jan. 18, 2003.

Commissioner Givens is a native of Rogersville where he grew up dairy, beef and tobacco farming. He is a U.S. Army veteran and holds a bachelor's degree in history and political science as well as a master's degree in political science from East Tennessee State University.

He was first elected to the state House of Representatives in 1988, and he served as chairman of the House Agriculture Committee from 1997 to 2002. He was the House of Representatives' designee to and served for four years on the Tennessee Tobacco Farmers Certifying Board, which administered Phase II tobacco settlement funds for growers.

Commissioner Givens is married to Connie Hall Givens, who serves as state director of the Coordinated School Health Program in the Department of Education. They have three grown children and one wonderful granddaughter, Zoë.



Joe Gaines

Assistant Commissioner of Agriculture, Tennessee Department of Agriculture

Joe R. Gaines is a native of Madison, Tennessee. He received his bachelor's degree in Forestry from the University of Tennessee-Knoxville and a master's degree in Public Administration from the University of Tennessee-Nashville. He is also a graduate of the Tennessee Government Executive Institute.

In 1996, Mr. Gaines was appointed to the position of Assistant Commissioner, Tennessee Department of Agriculture. In this position, he has overseen the creation of a comprehensive marketing and development program for Tennessee agriculture. Prior to 1996, Mr. Gaines held several positions in state government. He also served as executive director of the Governor's Council on Agriculture and Forestry.

Mr. Gaines is retired from the Tennessee Army National Guard holding the rank of Colonel and is the recipient of military awards including the Legion of Merit. He is the Past President of the North American Agricultural Marketing Officials, and is former Chairman of the Southern United States Trade Association.



Jeanie Nelson

President & Executive Director, Land Trust for Tennessee

Jeanie Nelson is a native of Nashville and graduated from Vanderbilt University with a Bachelor of Arts in English in 1969 and a J.D. in 1975. She practiced law in Nashville from 1975-1988 with Gullett, Sanford, Robinson and Martin.

From 1988-1992, she served as Chief Deputy Attorney General for Tennessee. From 1993-1998 she and her husband, Will Martin, lived in Washington, D.C. and held appointments in the Clinton Administration. She served as the General Counsel for the United States Environmental Protection Agency; followed by working in the White House as an environmental advisor to Vice President Gore and finally serving as director of the President's Crime Prevention Council.

She and her husband returned to Nashville at the end of 1998 at which time she founded The Land Trust for Tennessee with Phil Bredesen and a group of interested citizens to "preserve the unique character of Tennessee's natural and historic landscapes and sites for future generations."

Ms. Nelson is married to Will Martin and has two stepchildren--- Anne Martin, Nashville, TN, and Whit Martin, New York City.



Rhedona Rose

Director of Public Affairs, Tennessee Farm Bureau Foundation

Rhedona Rose began her career with the Tennessee Farm Bureau Federation in 1986 as the Assistant Director of Public Affairs. She is now the Director of the Public Affairs Department and the Legislative Lobbyist for the Organization. This includes up-to-date information on the various agriculturally related issues at both the state and national level.

Ms. Rose was active in the Future Farmers of America Work Experience Abroad (WEA) Program. Through WEA, she spent several months living and working on farms in both Japan and Italy. She served as State FFA Alumni President in 1988-89. She holds the Honorary FFA State and Honorary American Farmer Degree.

She received her bachelor's degree in Agricultural Science from Tennessee Tech in 1984 and her master's degree in Agricultural Development from Texas A&M University in 1986. In 1989, she was named the Outstanding Young Alumnus from Tennessee Technological University. Ms. Rose was also named the Distinguished Agricultural Alumnus from Tennessee Tech in 1997.



Dr. Ron Hanson

Neal Harlan Professor, University of Nebraska

Dr. Ron Hanson serves as the Neal Harlan Professor of Agribusiness in the Department of Agricultural Economics at the University of Nebraska. Professor Hanson's college teaching and student advising career has earned him over 26 university and national recognitions including the prestigious USDA Excellence in University Teaching Award from the U.S. Department of Agriculture. His highest career honor was earned by being named the Nebraska Professor of the Year by the Carnegie Foundation.

Ron was raised on an Illinois family farm in Henry County. Dr. Hanson earned his college degrees from Western Illinois University and the University of Illinois. He has counseled with Nebraska farm families for more than 30 years to help them resolve family conflicts in a more positive manner and to improve family relations through better communications.

Dr. Hanson is regarded as a widely traveled national speaker who shares an entertaining and motivating message with audiences. He focuses on the importance of family and personal relationships with other family members when farming and working together in a family owned business operation.

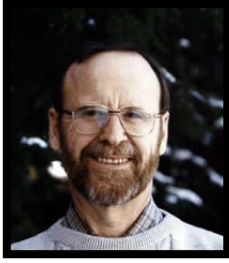

Dr. David Ostermeier

Professor, University of Tennessee

Dr. David Ostermeier specializes in natural resource policy and administration and holds degrees from the New York State College of Environmental Sciences & Forestry (Ph.D. in Natural Resource Economics, 1972), and M.S. and B.S. from the Universities of Missouri and Illinois, respectively. He has both teaching and research responsibilities and has been with the University of Tennessee since 1971 with the exception of two sabbaticals: 1978/79 academic year as Natural Resource Economist with the USDA in Washington, D.C.; and as Natural Resource Policy Advisor from 1991 until 1993 with the U.S. Agency for International Development in Indonesia. His teaching and research interests deal with the application of social sciences to natural resource management and use.



Emily Burnett Parish

Land Protection Manger, Land Trust for Tennessee

Emily B. Parish is the Land Protection Manager for the Land Trust for Tennessee. She graduated in 2002 from the University of the South (Sewanee, TN) magna cum laude with a bachelor's degree in Environmental Studies and Spanish. She also graduated in 2003 from the National Outdoor Leadership School's Outdoor Educator Program. Hired at the Land Trust in 2004 as a Land Protection Assistant, Emily has completed training in conservation easement stewardship and monitoring and has been promoted to her current position. As Land Protection Manager, Ms. Parish is responsible for the tracking and maintenance of all active projects, organizing and managing the stewardship and monitoring of all conservation properties and the baseline documentation reports for all conservation easements.

Ms. Parish is a true lover of the outdoors and spends most of her free time rock climbing and hiking with her husband Sam and dog Winnie.



John Rissler

Assistant State Conservationist, USDA/NRCS

John Rissler is Assistant State Conservationist for Programs for the Natural Resources Conservation Service (NRCS) in Tennessee. He graduated from Oklahoma State University in 1994 with a major in agriculture education. He has over 15 years experience in managing and implementing conservation programs in Oklahoma, Missouri, New York, Michigan and Texas.

As Assistant State Conservationist for Programs, he manages the NRCS easement programs including the Farm and Ranch Protection Program, the Grassland Reserve Program, the Healthy Forest Reserve Programs and Wetlands Reserve Program. In addition, he manages other conservation programs including the Environmental Quality Incentives Program, Wildlife Habitat Incentives Program, Conservation Stewardship Program, Cooperative Conservation Partnership Initiative and the Conservation Innovation Grants. Mr. Rissler also provides technical oversight for the Conservation Reserve Program and the Emergency Conservation Program. He is passionate about getting conservation on the ground to preserve and protect our natural resources.

Mr. Rissler, and his wife Carrie, and their two children reside in Fairview, Tennessee.



Steven Fisher

Tennessee Farmer

Steve Fisher and his wife Susan Fisher protected their farm in the Bethesda Community of Williamson County in 2002. The farm has been in Susan's family since 1848 and is a registered Tennessee Century Farm. Steve is the principal at the local elementary school and Susan is the local librarian. They currently raise sheep on the farm as they have been doing for many years. Steve and Susan plan to start a CSA once they retire in the next few years. The CSA program will provide local farm-fresh produce to members of their community. Photo by Nancy Rhoda.



Karen Guy

Tennessee Farmer

Karen Guy is a full-time cattle farmer in Davidson County. She protected her land, Hunter's Hill Farm, of 146 acres on Old Hickory Lake with The Land Trust for Tennessee in 2007. Ms. Guy worked many years at the Tennessee Department of Agriculture before turning to farming full time. She is an active member of the Tennessee Farm Bureau and the Davidson County Soil Conservation District. Photo by Nancy Rhoda.



John Allen

Staff Attorney, Comptroller of Treasury

John C. E. Allen is a staff attorney with the State of Tennessee, Comptroller of the Treasury. He performs work for the Division of Property Assessments, Office of State Assessed Properties, and Property Tax Relief. Before coming to work for the state of Tennessee, Mr. Allen worked in the real estate industry as a title examiner and a mortgage closer. He is also a member of the board of directors for the Autism Society of Middle Tennessee. Mr. Allen is a graduate of Ohio Northern University, Claude W. Pettit College of Law, in Ada, Ohio.



Barry Monson

*State Valuation Coordinator, Comptroller of the Treasury's
Division of Property Assessments*

Barry Monson is the State Valuation Coordinator for the State of Tennessee Comptroller of the Treasury's Division of Property Assessments. He is responsible for coordinating appraisal and assessment activities in all of Tennessee's 95 counties. Mr. Monson holds designations of both Tennessee Certified Assessor (TCA) and Tennessee Master Assessor (TMA) as awarded by the State Board of Equalization and has been designated as a Certified Public Administer by the University of Tennessee's Institute for Public Service. He is a member of various professional organizations including the International Association of Assessing Officers and the Institute for Real Estate Management. Mr. Monson is a recent Past President of the Tennessee Chapter of the International Association of Assessing Officers and currently serves on the organization's Executive Board.



Dr. Bridget Jones

Executive Director, Cumberland Region Tomorrow

Dr. Bridget Jones is Executive Director of Cumberland Region Tomorrow, a non-profit citizen-based organization dedicated to planning for the future livability and economic vitality of a 10-county region in middle Tennessee.

Dr. Jones is a native Middle-Tennessean. She holds degrees from the University of Memphis (B.B.A in Marketing/Transportation Logistics), Vanderbilt University (M.Ed. in Human Resource Development) and the University of Louisville (Ed.D. in Educational Administration).

Dr. Jones is Past-Chair of Columbia Main Street Corporation, a founding member and Board member of Maury Vision 20-20, a graduate of Leadership Maury and the Leadership Middle Tennessee Class of 2005 and serves on the Natchez Trace Parkway Association Board. She is an active member of the Smart Growth America Coalition and was named to the Board of Directors of Smart Growth America in March of 2008. Dr. Jones was appointed in February of 2005 by Tennessee Governor Phil Bredesen to the Southern Growth Policy Board, Global Strategies Council, where she will represent Tennessee on rural economic and community development issues and opportunities.



Tim Roach

Director of Local Planning, Tennessee Department of Economic and Community Development

Tim Roach is a native of Cookeville, Tennessee, where he attended Tennessee Technological University, earning a Bachelor of Science in Business Administration in 1982, and completing a Master of Business Administration in 1983. He joined the State of Tennessee's Department of Economic and Community Development in 1986 as a Community Planner in the Local Planning Assistance West Tennessee office. He has since been promoted to Director of Local Planning.

In this position he supervises the activities of six regional planning offices, serving over 215 local governments on a variety of land use and growth issues.

Recent Department developments have put Tim in charge of the Middle Tennessee field office. This position allows him to work both at the State and regional level to assist in implementing the full range of Community Development programs, focusing on strengthening communities to identify and fulfill their economic future and their future as a cohesive, sustainable community.



Larry Wilks

Larry D. Wilks has offices in Springfield and Nashville for his law firm, the Law Offices of Larry D. Wilks. He received his J.D. from the University of Tennessee College of Law and has been practicing in Tennessee since 1981.

Mr. Wilks served as president of the Tennessee Bar Association for 2006-2007, he served as Treasurer for the Tennessee Bar Association from 2000 until 2003, and he served as General Counsel to the Tennessee Bar Association from 1994 until 1999. He also served on the Supreme Court's Board of Professional Responsibility from 1993 until 1998. He currently serves as the Co-Chair for the Tennessee Bar Association's Leadership Law Program. He is a Fellow of the Tennessee Bar Foundation and a Fellow of the Nashville Bar Foundation. He is on the Board of the Tennessee Association for Justice and a member of the National Association of Criminal Defense Lawyers, the Tennessee Association of Criminal Defense Lawyers, and the American Association for Justice. Mr. Wilks is a member of the American, Tennessee, Nashville and Robertson County Bar Associations.



Gerry Cohn

Southeast Regional Director for American Farmland Trust

Gerry Cohn is the director of American Farmland Trust's Southeast Regional Office, which opened in October of 2000. His leadership responsibilities include educating communities, landowners and farmers in North Carolina, South Carolina, Kentucky, Tennessee and Georgia about the protection and importance of working lands.

While at AFT, Mr. Cohn has worked on the local level with county Agricultural District boards, at the state level developing the NC Agricultural Development and Farmland Preservation Program and at the federal level on AFT's Farm Policy Reform campaign.

Mr. Cohn has earned a Bachelor of Arts from the University of North Carolina, Master of Arts from the University of Dar Es Salaam in Tanzania, and Master of Science in agricultural economics from the University of California-Davis. A Chattanooga native, Cohn lives and farms in the North Carolina Piedmont.



Steve Auterman

Looney Ricks Kiss Architects, Inc.

Steve Auterman joined Looney Ricks Kiss in April of 2002, after five years at Urban Design Associates in Pittsburgh, and is now the lead of the Planning group in the Memphis office. His experience includes a broad range of urban design, multi-family and mixed-use projects, including small town, neighborhood and downtown master plans, HOPE VI public housing redevelopments, rental and for-sale multifamily projects, urban/rural public policy and strategic planning. Mr. Auterman considers rural Tennessee's natural and agricultural landscape, along with the charm and heritage of its small towns, one of the state's most under-valued resources. Fostering positive and sustainable built environments while also maintaining an integral connection to Tennessee's diverse landscape, termed Rural Stewardship, has become a focus of Mr. Auterman's work.



Hunter Gee

Looney Ricks Kiss Architects, Inc.

Hunter Gee joined Looney Ricks Kiss in 1998 and is the Director of Community Planning in the Nashville office. He has years of experience in a wide variety of architecture, planning and urban design projects across the country. Mr. Gee has led several urban infill mixed-use projects, such as the \$350-million Gulch Redevelopment Master Plan in Nashville, and has been involved with small town revitalization projects in Tennessee, Texas, Louisiana and Kentucky. He has led numerous large-scale, mixed-use projects focusing on sustainable solutions and conservation, including Lenox Village, Nashville's first Traditional Neighborhood Development. South Village, a conservation development in South Burlington, Vermont demonstrates Mr. Gee's practice of preserving and enhancing important ecological assets by leveraging quality sustainable growth.

Mr. Gee has spoken at a number of conferences and seminars, including a national roundtable on smart growth in Washington, D.C., and the "Designing with Density Workshop" in Raleigh, NC. He currently sits on Metro Nashville Planning Commission and, in 2007, was a recipient of the Nashville Emerging Leader Award presented by the Nashville Chamber of Commerce.



Caneta Hankins

Center for Historic Preservation

Caneta Skelley Hankins is the Assistant Director of the Center for Historic Preservation at Middle Tennessee State University and is also the Director of the Tennessee Century Farms Program. Over the years, Ms. Hankins has worked with organizations and individuals in each of the state's 95 counties. She has many publications to her credit including the forthcoming *Barns of Tennessee*. She also has conducted workshops and projects on historic farms and other heritage resources for educators and heritage organizations across Tennessee as well as other states and in Ireland, England and France.

A native Tennessean, Ms. Hankins is a graduate of Martin Methodist College and holds degrees from MTSU in history and historic preservation. She is the sixth generation of her family to live in Williamson County.



Rob Holland

Director, Center for Profitable Agriculture

Rob Holland was appointed Director of the Center for Profitable Agriculture in September 2007. Prior to his appointment as Director, Rob served as the Center's Financial Feasibility Specialist from April 1998 to August 2007 and served as an Extension Area Specialist in Farm Management from September 1993 to March 1998 covering ten counties in East Tennessee.

Mr. Holland received a Bachelor of Science in Agricultural Business from the University of Tennessee Martin in 1991 and a Master of Science in Agricultural Economics from the University of Tennessee Knoxville in 1993. In 2007, he graduated from the Corporate Leadership Development Program at Belmont University in Nashville.

Mr. Holland is a native of Giles County, Tennessee where he grew up on a small family farm and was a National 4-H winner. He has two children, a daughter named Reagan and a son named Clark.



Megan Bruch

Extension Specialists, Center for Profitable Agriculture

Megan Bruch (pronounced "Brew") joined the Center in June 2003 as a Marketing Specialist and focuses on marketing fundamentals and applied research. She provides leadership to the Center's programs, in agritourism, value-added fruit and vegetable products, farmers markets and other direct marketing channels.

Ms. Bruch is a native of Yuma, Colorado and was raised on a commercial cow/calf operation. She earned a Master of Science in Agricultural Economics with an emphasis in Marketing and a Bachelor of Science in Agricultural Business and Animal Science Industry from Colorado State University.



Dan Beasley

*Director of Rural Business-Cooperative Programs, USDA
Rural Development*

Dan Beasley is a native Tennessean who graduated Hendersonville high school in 1982 and the University of Tennessee - Knoxville in 1986.

He began work for the Farmers Home Administration (FMHA) in April of 1987 for Morgan County, TN as an Assistant County Supervisor (FMHA is the predecessor agency to Rural Development). In 1990, he transferred to the FMHA State Office as a Program Analyst, which included service as the Agency Management Control Officer, Appeals Coordinator, Public Information Coordinator and Freedom of Information Officer. In 1997, Mr. Beasley then transferred to the Rural Business- Cooperative Services (RBS) as a Rural Business and Cooperative Development Specialist and was named RBS Program Director for Tennessee in August 1998.

RBS is one of the Federal agencies which make up the USDA mission of Rural Development. RBS provides a wide array of loan, grant and technical assistance programs, which focus on job growth, business development and cooperative assistance in rural Tennessee.

Mr. Beasley currently resides in Hendersonville, Tennessee with his three children.



Jane Howell

Budget Analyst Coordinator and Tennessee Farmland Legacy Conference Coordinator, Tennessee Department of Agriculture

Jane Howell has been with the Tennessee Department of Agriculture since November 2007. During that time she worked as the Accountant for the Tennessee Agricultural Enhancement Program before becoming the Budget Analyst Coordinator for the Department. She also acts as a liaison for the Department with the Land Trust for Tennessee.

Ms. Howell grew up on a third-generation dairy farm in Morristown, Tennessee which is still operated by her parents. She has a Bachelor of Science in Agricultural Economics and Business from the University of Tennessee and a Master of Science in Agricultural Economics from Purdue University.

MONTGOMERY BELL CONFERENCE CENTER FLOOR PLAN

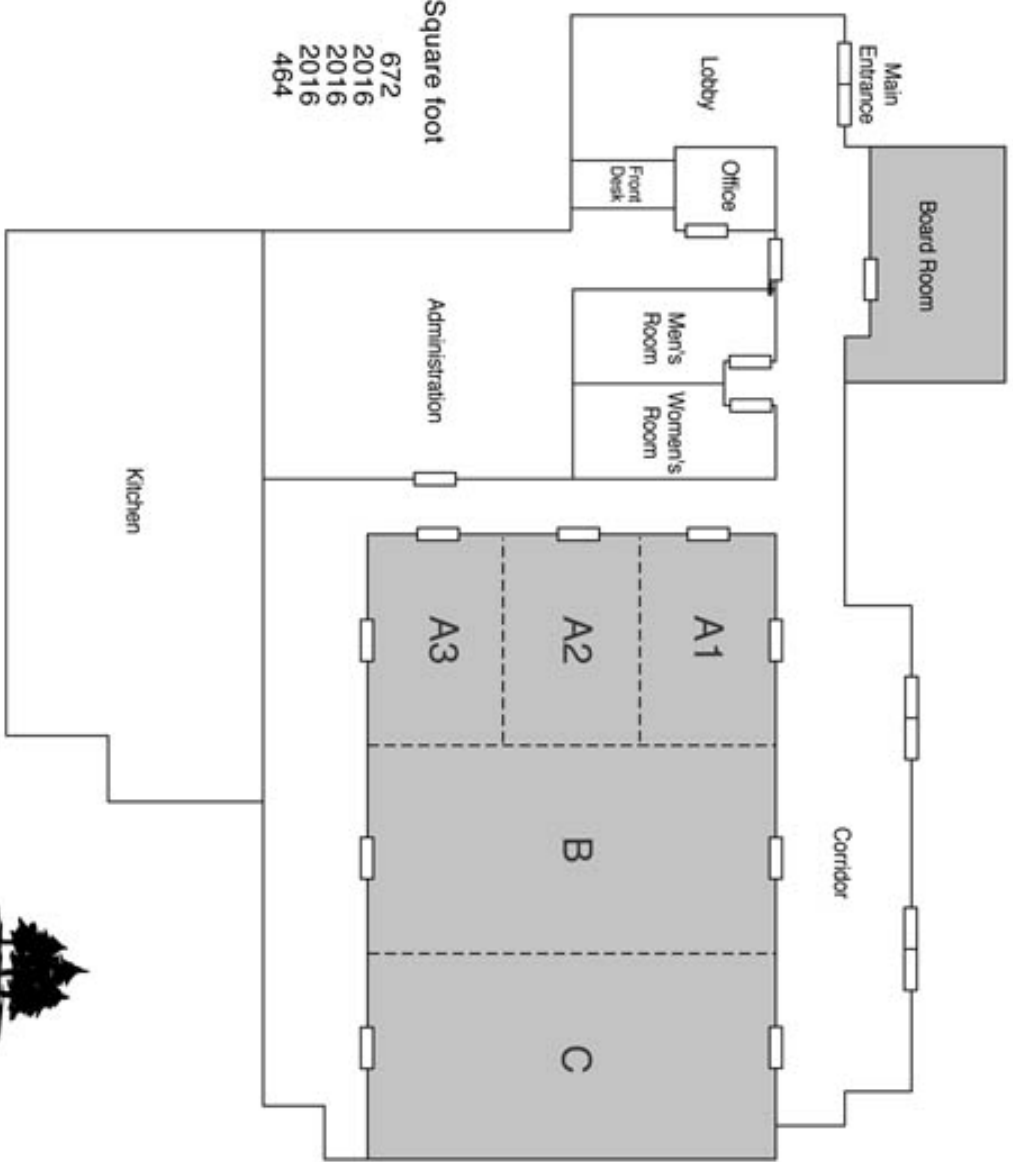

Meeting Area	Dimensions	Square foot
A1	32x21	672
A1, 2, & 3	32x63	2016
B	32x63	2016
C	32x63	2016
Board Room	29x16	464



